



**International
Standard**

ISO 5216

**Commercial road vehicles —
Ball-bearing turntable —
Interchangeability**

Véhicules routiers utilitaires — Plateau tournant à roulement à billes — Interchangeabilité

**First edition
2024-04**

STANDARDSISO.COM : Click to view the full PDF of ISO 5216:2024

STANDARDSISO.COM : Click to view the full PDF of ISO 5216:2024



COPYRIGHT PROTECTED DOCUMENT

© ISO 2024

All rights reserved. Unless otherwise specified, or required in the context of its implementation, no part of this publication may be reproduced or utilized otherwise in any form or by any means, electronic or mechanical, including photocopying, or posting on the internet or an intranet, without prior written permission. Permission can be requested from either ISO at the address below or ISO's member body in the country of the requester.

ISO copyright office
CP 401 • Ch. de Blandonnet 8
CH-1214 Vernier, Geneva
Phone: +41 22 749 01 11
Email: copyright@iso.org
Website: www.iso.org

Published in Switzerland

Contents		Page
Foreword.....		iv
1	Scope.....	1
2	Normative references.....	1
3	Terms and definitions.....	1
4	Standard ball-bearing turntables geometrical requirements.....	2
4.1	Radial section.....	2
4.2	Fixing holes.....	3
5	Designation.....	3
Bibliography.....		4

STANDARDSISO.COM : Click to view the full PDF of ISO 5216:2024

Foreword

ISO (the International Organization for Standardization) is a worldwide federation of national standards bodies (ISO member bodies). The work of preparing International Standards is normally carried out through ISO technical committees. Each member body interested in a subject for which a technical committee has been established has the right to be represented on that committee. International organizations, governmental and non-governmental, in liaison with ISO, also take part in the work. ISO collaborates closely with the International Electrotechnical Commission (IEC) on all matters of electrotechnical standardization.

The procedures used to develop this document and those intended for its further maintenance are described in the ISO/IEC Directives, Part 1. In particular, the different approval criteria needed for the different types of ISO document should be noted. This document was drafted in accordance with the editorial rules of the ISO/IEC Directives, Part 2 (see www.iso.org/directives).

ISO draws attention to the possibility that the implementation of this document may involve the use of (a) patent(s). ISO takes no position concerning the evidence, validity or applicability of any claimed patent rights in respect thereof. As of the date of publication of this document, ISO had not received notice of (a) patent(s) which may be required to implement this document. However, implementers are cautioned that this may not represent the latest information, which may be obtained from the patent database available at www.iso.org/patents. ISO shall not be held responsible for identifying any or all such patent rights.

Any trade name used in this document is information given for the convenience of users and does not constitute an endorsement.

For an explanation of the voluntary nature of standards, the meaning of ISO specific terms and expressions related to conformity assessment, as well as information about ISO's adherence to the World Trade Organization (WTO) principles in the Technical Barriers to Trade (TBT), see www.iso.org/iso/foreword.html.

This document was prepared by Technical Committee ISO/TC 22, *Road vehicles*, Subcommittee SC 40, *Specific aspects for light and heavy commercial vehicles, busses and trailers*.

Any feedback or questions on this document should be directed to the user's national standards body. A complete listing of these bodies can be found at www.iso.org/members.html.

Commercial road vehicles — Ball-bearing turntable — Interchangeability

1 Scope

This document specifies dimensions of ball-bearing turntable when mounted on a vehicle which is part of vehicle combinations specified in of ISO 18868:2013, Clause 4, to ensure their interchangeability.

This document also applies to the following:

- drawbar trailers using a ball-bearing turntable to steer the front axle;
- ball-bearing turntables assembled with the fifth-wheel of the road tractor (truck) to improve steering manoeuvre.

2 Normative references

There are no normative references in this document.

3 Terms and definitions

For the purposes of this document, the following terms and definitions apply.

ISO and IEC maintain terminology databases for use in standardization at the following addresses:

- ISO Online browsing platform: available at <https://www.iso.org/obp>
- IEC Electropedia: available at <https://www.electropedia.org/>

3.1

ball-bearing turntable

ball race

bearing built specifically for trailer and semi-trailer application to enable the rotation of the swivelling support attached to the vehicle chassis, supporting vertical and horizontal loads and suitable for the application under a fifth wheel coupling

Note 1 to entry: See [Figure 1](#).

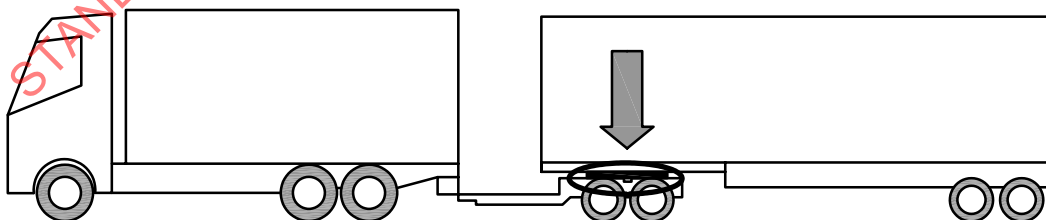

Figure 1 — Example of ball-bearing location

4 Standard ball-bearing turntables geometrical requirements

4.1 Radial section

The radial section shall be one of the types shown in [Figure 2](#). Dimensions of the types shall be according to [Table 1](#). Dimensions not specified are left to the discretion of the component manufacturer.

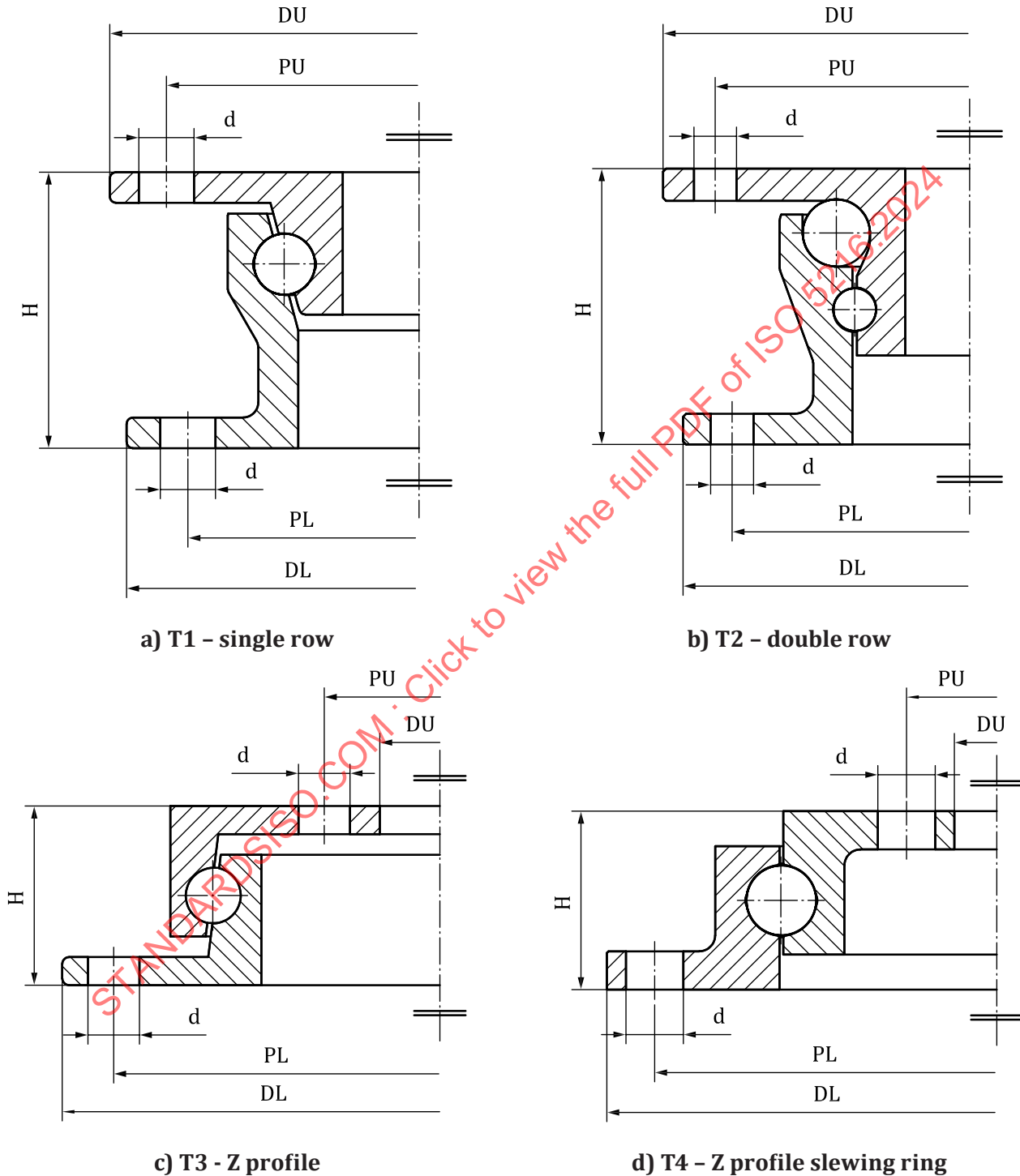

Figure 2 — Radial section types

Table 1 — Overall dimensions

TYPE	DL (max.) [mm]	PL [mm]	DU (max.) [mm]	PU [mm]	d [mm]	H [mm]	Axial load (min.) [kN]
T1	995	952	1 006	966	18	90	-
	1 005	960	1 016	974	18	90	70
	1 105	1 060	1 116	1 074	18	90	80
	1 205	1 160	1 216	1 174	18	90	130
	1 305	1 260	1 316	1 274	18	90	140
T2	881	852	895	866	16	80	80
	1 096	1 060	1 109	1 074	16	80	100
	988	952	1 001	966	18	90	120
	1 096	1 060	1 109	1 074	18	90	130
	1 196	1 160	1 208	1 174	18	90	100
TYPE	DL (max.) [mm]	PL [mm]	DU (min.) [mm]	PU [mm]	d [mm]	H [mm]	Axial load (min.) [kN]
T3	510	475	300	340	-	52	18
	660	625	450	490	-	52	25
	760	725	550	590	-	52	30
	860	825	650	690	-	52	35
	960	925	750	790	-	52	40
	1 060	1 025	850	890	-	52	45
T4	525	490	300	332	18	56	40
	655	620	430	462	18	56	80
	755	720	530	562	18	56	120
	855	820	630	662	18	56	150
	955	920	730	762	18	56	180
	1 055	1 020	830	862	18	56	210
	1 205	1 170	980	1 012	18	56	250

4.2 Fixing holes

Fixing holes are defined only by their dimension “d” and circle dimension “PU” and “PL”. Fixing holes distribution is defined by the ball-bearing turntables manufacturer.

5 Designation

Ball races in conformance with the requirements of this document shall be designated as follows:

- reference to this document;
- number of type according to [Figure 2](#);
- DL dimension according to [Table 1](#);
- axial load according to [Table 1](#).

EXAMPLE

— Ball-Bearing Turntable ISO xxxxx T1-1005-70

Bibliography

- [1] ISO 18868:2013, *Commercial road vehicles — Coupling equipment between vehicles in multiple vehicle combinations — Strength requirements*

STANDARDSISO.COM : Click to view the full PDF of ISO 5216:2024